

SOD-323 Switching Diode 开关二极管

■ **Features 特点**

Fast Switching Speed 快的开关速度
Surface mount device 表面贴装器件
High Conductance 高电导率
Case 封装:SOD-323
Marking 印字: T4

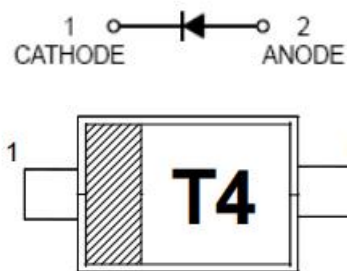

■ **Maximum Rating 最大额定值**

($T_A=25^{\circ}\text{C}$ unless otherwise noted 如无特殊说明, 温度为 25°C)

Characteristic 特性参数	Symbol 符号	Rating 额定值	Unit 单位
Non-Repetitive Peak Reverse Voltage 不重复反向峰值电压	V_{RM}	100	V
DC Reverse Voltage 直流反向电压	V_R	80	V
Forward Rectified Output Current 正向工作电流	I_O	150	mA
Non-Repetitive Peak Surge Current(@ $t=1\mu\text{s}$) 不重复峰值浪涌电流	I_{FSM}	0.5	A
Power Dissipation 耗散功率	P_D	200	mW
Thermal Resistance Junction-Ambient 结到环境热阻	$R_{\theta JA}$	625	$^{\circ}\text{C}/\text{W}$
Junction/Storage Temperature 结温/储藏温度	T_J, T_{stg}	-50to+150 $^{\circ}\text{C}$	$^{\circ}\text{C}$

■ **Electrical Characteristics 电特性**

($T_A=25^{\circ}\text{C}$ unless otherwise noted 如无特殊说明, 温度为 25°C)

Characteristic 特性参数	Symbol 符号	Min 最小值	Max 最大值	Unit 单位	Condition 条件
Reverse Voltage 反向电压	V_R	80		V	$I_R=100\mu\text{A}$
Forward Voltage 正向电压	V_F	0.62	0.72 0.855 1.0 1.25	V	$I_F=5\text{mA}$ $I_F=10\text{mA}$ $I_F=100\text{mA}$ $I_F=150\text{mA}$
Reverse Current 反向电流	I_R		100 25 50 30	nA nA μA μA	$V_R=80\text{V}$ $V_R=20\text{V}$ $V_R=75\text{V}, T_J=150^{\circ}\text{C}$ $V_R=20\text{V}, T_J=150^{\circ}\text{C}$
Junction Capacitance 结电容	C_J		4	pF	$V_R=0.5\text{V}, f=1\text{MHz}$
Revers Recovery Time 反向恢复时间	T_{rr}		4	nS	$I_{rr} = 0.1 \cdot I_R, I_F = I_R = 10\text{mA}, R_L = 100\Omega$

■ Typical Characteristic Curve 典型特性曲线

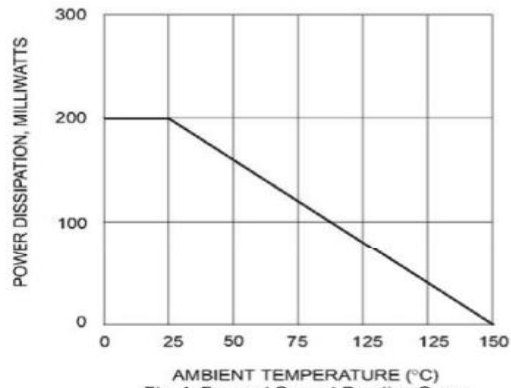

Fig. 1 Forward Current Derating Curve

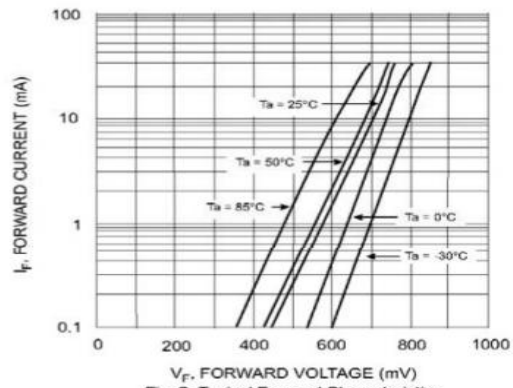

Fig. 2 Typical Forward Characteristics

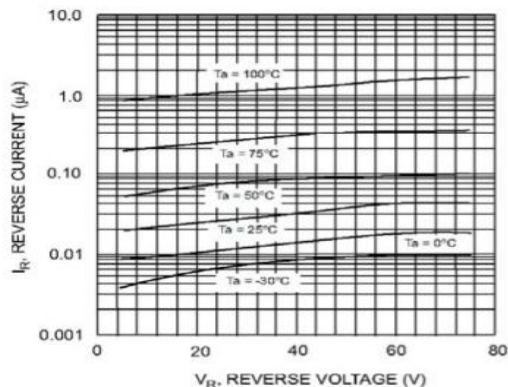

Fig. 3 Typical Reverse Characteristics

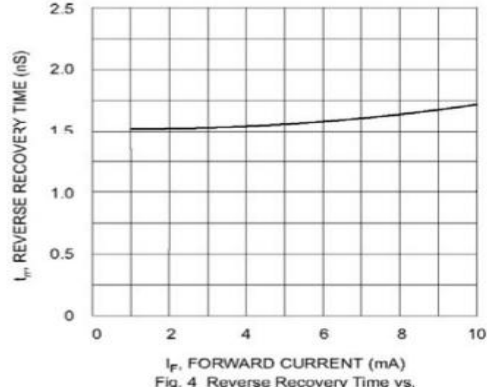
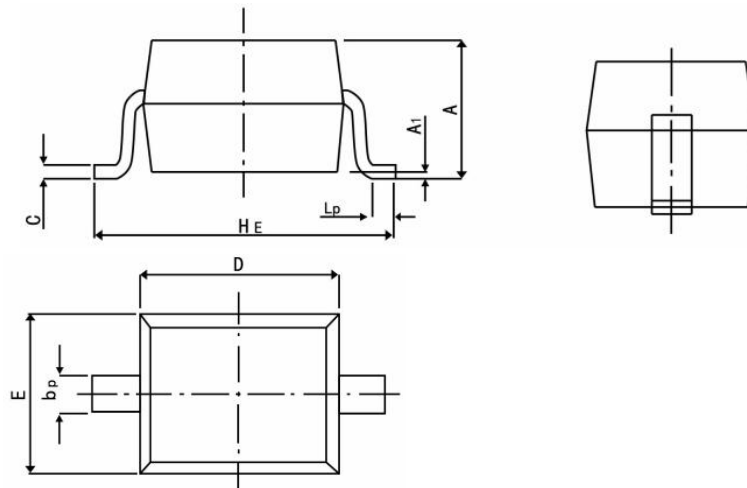

Fig. 4 Reverse Recovery Time vs. Forward Current

■ Dimension 外形封装尺寸



(mm)	A	bp	C	D	E	HE	A ₁	Lp
Min	0.9	0.25	0.1	1.6	1.15	2.3	0.01	0.2
Max	1.2	0.4	0.15	1.8	1.35	2.8	0.1	0.5